



RESIDENTIAL LOUVRE SYSTEMS

Operation/Maintenance/Warranty



Table of Contents

PRODUCT COMPLIANCE	3
PRODUCT & OPERATION DETAILS	4
Sunlite Shutter Panels	4
Sunlite Privacy Screen.....	6
Sunlite Sliding panels – 90 blade.....	8
Sunlite Sliding panels – Slats	9
Sunlite Bi-fold Panels.....	10
Sunlite Slatted Screens & gate / door.....	11
Sunlite Louvre Awnings – 90 blade.....	12
Sunlite Modular Fins.....	13
Sunlite Swaged Screens	14
Sunlite Perforated Screens	15
Sunlite Airflow panels & gate / door	16
MAINTENANCE INFORMATION	17
Louvre blades.....	17
Gutters & downpipes.....	17
Fixings	17
Safetech Viper Latch	17
Panel locks	17
Somfy (electrical items)	18
Centor rollers	18
Bottom track guide	19
Powdercoated metal work.....	19
Anodised metal work	20
REPAIR / MAINTENANCE WORKS.....	21
MAINTENANCE FORM.....	22
WARRANTY.....	23
CONTACT DETAILS	24



PRODUCT COMPLIANCE

Sunlite products have been designed and produced using premium grade components and materials to ensure extended product life with minimal maintenance requirements.

All aluminium components, welding, fasteners, nylon bushes and finish coatings comply with the applicable portions of the Australian Standards.

All extruded aluminium components will be manufactured from aluminium alloy 6060 temper T5 or T6, unless otherwise requested by project specifications.

All stainless-steel components are Architectural Grade 304 and/or Marine Grade 316 as per project specification.

All plastics are external grade self-lubricating nylon, for louvre blade rotation.

Exclusions – structural steel support members, packing members except horse-shoe shims.

All work shall be performed by experienced tradesmen familiar with the quality required in this area of work.



PRODUCT & OPERATION DETAILS

Sunlite Shutter Panels

DESCRIPTION OF PRODUCT

Sunlite 90mm elliptical louvre blades within aluminium angle / shutter frame. Refer to your copy of approved Sunlite shop drawings for specific details.

OPERATION

Panel: Panel is fixed into existing opening and cannot be retracted or operated.

Blades (fixed): Blades are set at fixed pitch / spacings and cannot be operated.

Blades (manual): Louvre blades are hand operable via nylon end caps and self-lubricating bushes allowing rotation of the louvre blades. To adjust the pitch of the louvre blade hand grasp a louvre blade (with one or two hands to alternate blades where possible) and rotate blade from a closed position through 90 degrees of rotation to fully open position. Fully closed are blades closed against each other with minimal light transfer, fully open blades are horizontal to the horizon, with maximum light transfer.

Blades (electric): Blades will be electrically operable via Sunlite custom aluminium motor blade (one per bay) and a combination of aluminium laser cut end caps (operation side) and nylon end caps with self-lubricating bushes.

Somfy 240V motor is fitted by a licensed electrician, within the Sunlite motor blade and comes with the below electrical components:

- Somfy LS40 with 40mm octagonal crown / wheel connectors;
- Somfy wireless Solaris RTS receivers with hirschmann plugs
- Somfy Situo Variation 1 remote control (*for single bay only*)
- Somfy Situo Variation 5 remote control (*for multiple bays*) with multi channel programming allowing panels to operate separately and simultaneously.

Sunlite will ensure the remote is programmed and operation/rotation limits are set on the motor, prior to the installers leaving site (where possible). For any assistance with commissioning/wiring or programming once installed we recommend contacting Somfy Technical advice line 1800 076 639 or via website <https://www.somfy.com.au/support>

Blades can either be rotated to full open position or full closed position using the arrow buttons on the remote provided. Blades can also be gradually opened or closed using the scroll wheel. Please see below instructions on operating Somfy remote control (*Somfy manual attached also*)

1. Adjusting the louvres to your preferred pitch is to be done using the wheel in the centre of the remote. Up/Down or Left/Right (Depending on controller type) will operate the blades in different directions. You can also use the buttons at the top/bottom of the controller to open and close the blades to the set limits in both directions.



- Multiple bay panels will require the bay you wish to operate to be selected (multiple bay controllers only). The bay to be operated is shown by a red light on the controller. Shift bays by pressing the bottom button and visually check the red light on the controller to make sure the correct bay is active. Having all 4 lights on will operate all bays simultaneously.
- To close the louvres to shut position you MUST open the blades completely and use the OPEN/CLOSE buttons only. Closing the blades shut using only the roller wheel will not get a complete close for your product.

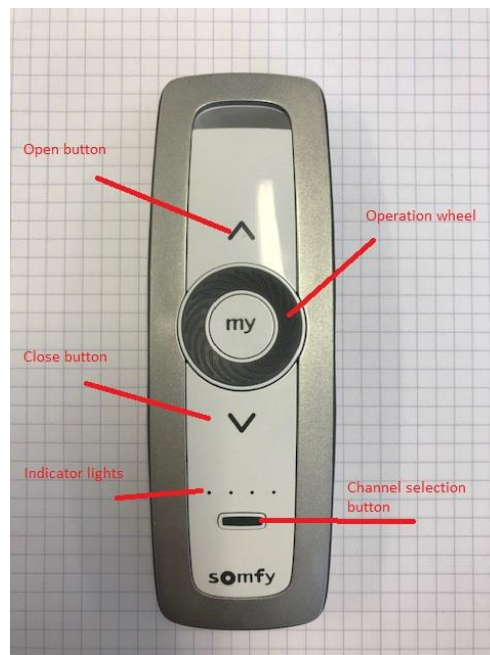



Sunlite Privacy Screen

DESCRIPTION OF PRODUCT

Sunlite 180mm elliptical blades within aluminium frame. Refer to your copy of approved Sunlite shop drawings for specific details.

OPERATION

Panel: Panel is fixed into existing opening with either aluminium angle / channel or with commercial 100mm subframing (subhead / subsill). Panel cannot be moved.

Blades (fixed): Blades are set at fixed pitch / spacings and cannot be operated.

Blades (manual): Louvre blades are hand operable via nylon end caps and self-lubricating bushes allowing rotation of the louvre blades. To adjust the pitch of the louvre blade hand grasp a louvre blade (with one or two hands to alternate blades where possible) and rotate blade from a closed position through 90 degrees of rotation to fully open position.

Blades (electric): Blades will be electrically operable via Sunlite custom aluminium motor blade (one per bay) and a combination of aluminium laser cut end caps (operation side) and nylon end caps with self lubricating bushes.

Somfy 240V motor is fitted by licensed electrician within Sunlite motor blade and comes with below electrical components:

- Somfy Vectran 50/12 motor with Zamack bracket and 60mm octagonal crown / wheel connectors;
- Somfy wireless Solaris RTS receivers with hirschmann plugs
- Somfy Situo Variation 1 remote control (*for single bay only*)
- Somfy Situo Variation 5 remote control (*for multiple bays*) with multi channel programming allowing panels to operate separately and simultaneously.

Sunlite will ensure the remote is programmed and operation/rotation limits are set on the motor, prior to the installers leaving site (where possible). For any assistance with commissioning/wiring or programming once installed we recommend contacting Somfy Technical advice line 1800 076 639 or via website <https://www.somfy.com.au/support>

Blades can either be rotated to full open position or full closed position using the arrow buttons on the remote provided. Blades can also be gradually opened or closed using the scroll wheel. Please see below instructions on operating Somfy remote control (*Somfy manual attached also*)

1. Adjusting the louvres to your preferred pitch is to be done using the wheel in the centre of the remote. Up/Down or Left/Right (Depending on controller type) will operate the blades in different directions. You can also use the buttons at the top/bottom of the controller to open and close the blades to the set limits in both directions.



2. Multiple bay panels will require the bay you wish to operate to be selected (multiple bay controllers only). The bay to be operated is shown by a red light on the controller. Shift bays by pressing the bottom button and visually check the red light on the controller to make sure the correct bay is active. Having all 4 lights on will operate all bays simultaneously.
3. To close the louvres to shut position you MUST open the blades completely and use the OPEN/CLOSE buttons only. Closing the blades shut using only the roller wheel will not get a complete close for your product.

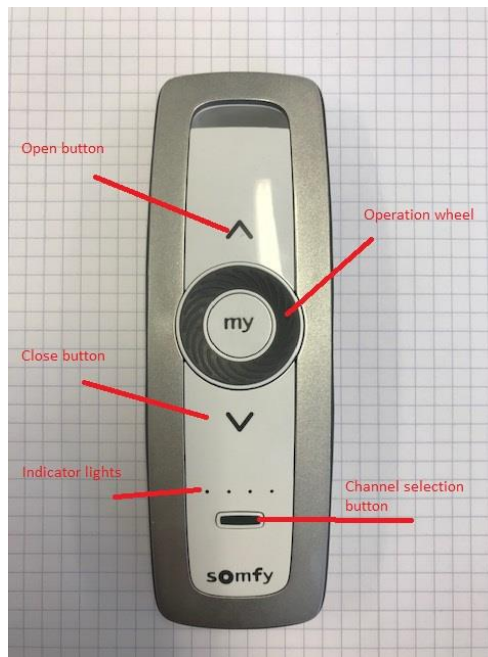



Sunlite Sliding Panels – 90 blade

DESCRIPTION OF PRODUCT

Sunlite 90mm elliptical louvre blades within full perimeter aluminium shutter frame. Sunlite top track and bottom channel installed to existing structure. 2 x stainless steel rollers installed to the top of each panel and 2 x polyrock bottom guides installed into bottom channel allow panels to slide. Refer to your copy of approved Sunlite shop drawings for specific details.

OPERATION

Panel: The position of the louvre panels can be altered by sliding the panels along the track provided.

To move the louvres along the tracks, apply firm and even pressure by hand to the side of the louvre panel frame, at a 2/3 position from the bottom of the panel, the higher the pressure position the easier they will be to move, due to the panels being top hung. Panels should slide along the top track easily and smoothly. Top track & carriages require maintenance as per below instructions.

Locking the panels in a fixed position via the face mounted flush lock (FMFL). Locking is advisable at all times for high wind protection. Pushing the FMFL control handle vertically down will engage the pin into locking position when aligned with locking hole. Pushing the FMFL control handle vertically up will disengage the locking pin and allow the panel to move freely along the track.

Blades (fixed): Blades are set at fixed pitch / spacings and cannot be operated.

Blades (manual): Louvre blades are hand operable via nylon end caps and self-lubricating bushes allowing rotation of the louvre blades. To adjust the pitch of the louvre blade hand grasp a louvre blade (with one or two hands to alternate blades where possible) and rotate blade from a closed position through 90 degrees of rotation to fully open position. Fully closed is blades closed against each other with minimal light transfer, fully open blades are horizontal to the horizon, with maximum light transfer.



Sunlite Sliding Panels – Slats

DESCRIPTION OF PRODUCT

Sunlite aluminium RHS slats within full perimeter aluminium SHS frame or shutter frame. Sunlite top track and bottom channel installed to existing structure. 2 x stainless steel rollers installed to the top of each panel and 2 x polyrock bottom guides installed into bottom channel allow panels to slide. Refer to your copy of approved Sunlite shop drawings for specific details.

OPERATION

Panel: The position of the louvre panels can be altered by sliding the panels along the track provided.

To move the louvres along the tracks, apply firm and even pressure by hand to the side of the louvre panel frame, at a 2/3 position from the bottom of the panel, the higher the pressure position the easier they will be to move, due to the panels being top hung. Panels should slide along the top track easily and smoothly. Top track & carriages require maintenance as per below instructions.

Locking the panels in a fixed position via the face mounted flush lock (FMFL). Locking is advisable at all times for high wind protection. Pushing the FMFL control handle vertically down will engage the pin into locking position when aligned with locking hole. Pushing the FMFL control handle vertically up will disengage the locking pin and allow the panel to move freely along the track.

Blades (fixed): Blades are set at fixed pitch / spacings and cannot be operated.



Sunlite Bi-fold Panels

DESCRIPTION OF PRODUCT

Sunlite 90mm elliptical louvre blades within full perimeter aluminium shutter frame. Bi-fold top track, bottom track and side jambs installed to existing structure. 2 x stainless steel rollers installed to the top of each panel and 2 x polyrock bottom guides installed into bottom channel allow panels to slide. Refer to your copy of approved Sunlite shop drawings for specific details.

OPERATION

Panel: Louvre panels are bi-folding, meaning they can manually concertina (or fold) to the side walls via the top track and bottom guide sliding system. The panels are individually hinged to each other and have a 4 panel and 2 panel configurations, with 4 panels folding towards one wall and 2 panels folding towards the opposite wall. Panels can be positioned across balcony for full coverage or all panels can be folded away into stacked position for a fully open balcony. Blade operation is only available when the panels are in a full coverage position, and blade operation is hand operable via blade handle. Blades pivot from a fully closed position (minimal light) through 90 degrees at a fully open position (maximum light) and continue to 160 degrees of rotation to privacy setting (reflected light). Louvre blades require usage every 2 – 3 weeks to keep operating system active and free of salt / dust / grim build up. Blades have to be fully closed for bi-folding operation, damage to panels and blades will occur if panels are bi-folded with blades in any other position but closed.

Each bi-fold panel is fitted with a (FMFL) flush bolt for positioning panel in a full balcony coverage position, with the flush bolts to each panel required to be disengaged for bi-folding action. The last panel to each set of bi-fold panels has a flush bolt fitted to the lower side of framework for locking bi-fold stack in a fixed stacked position. Please note if bi-fold panels are left unlocked with flush bolt pins not positioned into locking holes high wind will damage the panels.

To move the louvres along the tracks, disengaging all flush bolts, apply firm and even pressure by hand to the side of the louvre panel frame, at a 2/3 position from the bottom of the panel, the higher the pressure position the easier they will be to move, due to the panels being top hung. Panels should slide along the top track easily and smoothly. To a stacked wall position and then engage the lower side of framework lock bolt to lock panels in a stacked position. Bi-fold top track & carriages require maintenance as per below instructions.

Blades (fixed): Blades are set at fixed pitch / spacings and cannot be operated.

Blades (manual): Louvre blades are hand operable via nylon end caps and self-lubricating bushes allowing rotation of the louvre blades. To adjust the pitch of the louvre blade hand grasp a louvre blade (with one or two hands to alternate blades where possible) and rotate blade from a closed position through 90 degrees of rotation to fully open position. Fully closed is blades closed against each other with minimal light transfer, fully open blades are horizontal to the horizon, with maximum light transfer. Louvre blades require usage every 2 – 3 weeks to keep operating system active and free of salt / dust / grim build up.



Sunlite Slatted Screens & gate / door

DESCRIPTION OF PRODUCT

Sunlite 65x16 aluminium RHS slats within 50x3 aluminium SHS frame. Gate / door fitted with Safetech Viper latch and Kwikfit hinges. Refer to your copy of approved Sunlite shop drawings for specific details.



OPERATION

Panel: Panel is fixed into existing opening and cannot be moved.

Door / Gate: If door / gate panel has been installed, panel will swing either inwards or outwards on hinges. Must be closed securely during high winds to avoid damage to frame / hardware.

Blades (fixed): Blades are set at fixed pitch / spacings and cannot be operated.



Sunlite Louvre Awnings – 90 blade

DESCRIPTION OF PRODUCT

Sunlite Louvre / Aerolone awnings are made with 90mm elliptical louvre blade fixed into custom shaped aluminium outriggers. Aerolone awnings have an added elliptical nosing section fixed to the front visual edge. Blades to be set at 90 centres. Awnings to be fixed to existing structure via 125x50x6mm angle and custom outriggers if required. Refer to your copy of approved Sunlite shop drawings for specific details.

OPERATION

Panel: Awning is fixed and cannot be retracted / operated.

Blades (fixed): Blades are set at fixed pitch / spacings and cannot be operated.

Blades (manual): Louvre blades are hand operable via nylon end caps and self-lubricating bushes allowing rotation of the louvre blades. To adjust the pitch of the louvre blade hand grasp a louvre blade (with one or two hands to alternate blades where possible) and rotate blade from a closed position through 90 degrees of rotation to fully open position. Fully closed is blades closed against each other with minimal light transfer, fully open blades are horizontal to the horizon, with maximum light transfer.



Sunlite Modular Fins

DESCRIPTION OF PRODUCT

Modular section 45mm / 50mm / 75mm wide which are 'snapped' together to create custom projections. Refer to your copy of approved Sunlite shop drawings for specific details.

OPERATION

Panel: Awning is fixed and cannot be retracted / operated.

Blades (fixed): Blades are set at fixed pitch / spacings and cannot be operated.



Sunlite Swaged Screens

DESCRIPTION OF PRODUCT

Locker Group swaged panels fixed within aluminium framework. Refer to your copy of approved Sunlite shop drawings for specific details.

OPERATION

Panel: Awning is fixed and cannot be retracted / operated.

Blades (fixed): Blades are set at fixed pitch / spacings and cannot be operated.



Sunlite Perforated Screens

DESCRIPTION OF PRODUCT

Aluminium perforated sheets fitted within aluminium framework. Refer to your copy of approved Sunlite shop drawings for specific details.

OPERATION

Panel: Awning is fixed and cannot be retracted / operated.

Blades (fixed): Blades are set at fixed pitch / spacings and cannot be operated.



Sunlite Airflow panels & gate / door

DESCRIPTION OF PRODUCT

Sunlite single or double water stop louvre blades within aluminium angle or full perimeter frame.

Gate / door fitted with Safetech Viper latch and Kwikfit hinges. Refer to your copy of approved Sunlite shop drawings for specific details.



OPERATION

Panel: Panel is fixed into existing opening and cannot be moved.

Door / Gate: If door / gate panel has been installed, panel will swing either inwards or outwards on hinges. Must be closed securely during high winds to avoid damage to frame / hardware.

Blades (fixed): Blades are set at fixed pitch / spacings and cannot be operated.



MAINTENANCE INFORMATION

A maintenance log must be maintained on all aluminium items, locks, handles, bearings etc to support any warranty claims. This must detail all products used and all works undertaken, who performed the works and show clear signatures. The basic maintenance requirement is to keep the system clean and free from deposits which may hinder the operation of the system with specific considerations noted as follows:

Louvre blades

The louvre blades are made operable by a system which incorporates nylon bushes and louvre blade end caps. Nylon is a self-lubricating material and no additional lubrication is either necessary or advised. Sunlite louvre blades should be operated at least every 2-3 weeks to ensure free movement and prevent contaminants attacking the operating gear. In a coastal environment cleaning and operation of louvre blades on a regular basis is essential to avoid operational issues.

Gutters & downpipes

Gutters and downpipes should be checked and cleaned on a 2-3 month basis to avoid any build-up of leaves and / or other debris.

Fixings

All fixings should be visually inspected every 6 months. We recommend random sampling of fixing tension - at least 10% of each level on each face / area. These tests and inspections need to be recorded in a maintenance / testing log for any warranty claims to be assessed.

Stainless steel fixings should be cleaned regularly to avoid tea staining (especially in coastal environments) and to keep them in perfect condition. Avoid using abrasive brushes or strong detergents as these can cause scratches or fading of the surface. A soft cloth and ordinary soap or detergent will suffice.

Safetech Viper Latch

Please see "Safetech hardware" warranty and maintenance document attached.

Panel locks

Alspec face mounted flush bolt (FMFB) 26mm satin chrome finish with nylon tips.

Visible surfaces should be cleaned using a damp cloth and mild detergent, then wiped dry. Apply a light application of lubricant to internal mechanisms and bolt using a suitable nozzle-spray. There are access holes and slots so that this can be done within removing the lock from the screen. Stainless steel will gradually discolour over time. This discolouration can be maintained if the above described cleaning and treating is carried out on a maximum 3 month basis.



Stainless Steel spring loaded locking bolt

Stainless steel should be cleaned regularly to avoid discolouration (especially in coastal environments) and to keep them in perfect shape. Avoid using abrasive brushes or strong detergents as these can cause scratches or fading of the surface. A soft cloth and ordinary soap or detergent will suffice.



Somfy (electrical items)

Warranty for electrical hardware and motors attached. For any electrical issues please contact Somfy directly on 1800 076 639 or via website <https://www.somfy.com.au/support>

Centor rollers

Centor warranty attached. The overhead track system should be kept free of debris, which may impede the smooth operation of the carriage wheels. It is recommended that cleaning is carried out using a soft brush and/ or vacuum cleaner. Maintenance schedule for cleaning of tracks should be followed for tracks especially in a high debris area's (beachside, city, high wind dusty situation).

The carriage wheels have bearings pre-packed with grease and do require lubrication. As per "Centor" manufacturer's maintenance instructions below:

"Using a spatula or similar (not your finger), apply a small amount (typically a 1/4 teaspoon) of white petroleum jelly (Vaseline) or similar lubricant to the inner lip of each side of the track. Ensure that the wheels pass through the lubricant and it is distributed evenly along the track. Put additional lubricant around bearings. Lubricant reduces wear, improves smoothness and further protects against corrosion of track and bearings. Remove all surface contaminants by wiping all visible track surfaces with a damp soft cloth and a mild detergent, then wipe clean with a clean cloth."

In severe environments, apply a thin film of a corrosion preventative such as CRC Marine 66, Inox or WD40, by wiping with a soft cloth moistened with one of these products.

Stainless-steel bearings are manufactured from hardening-grade stainless-steel and although this material performs considerably better than plated steels, it is still susceptible to corrosion unless maintained as described above.



Bottom track guide

The bottom sliders are produced from self-lubricating Polyrock plastic, offering outwards pressure on the track whilst panels are sliding to stop wind shaking / rattling panels. The polyrock bottom guide is fitted with custom designed stainless steel pins. No additional lubrication is required, but it is important to not allow the build up of dirt in the track which may impede the operation of the slider.

It is recommended that the bottom track is cleaned out regularly using a soft brush and / or vacuum cleaner, especially in high debris areas (beachside, city, high wind dusty situations). Cleaning should be carried out on a 3-6 month basis depending on debris build up.

Powdercoated Finish

The complete louvre system including the framework, blades and tracks are fabricated from aluminium extrusions and have a factory applied polyester powder paint finish, which is oven baked.

The paint warranty on these components is for 10 years, with an expected life of 20 years plus (unless stated otherwise).

Cleaning is desirable if the fine finish of powder-coated aluminium is to be preserved. Deterioration of the coating occurs mainly as a result of grime deposition and attack by contaminated moisture, which in a coastal environment contains chlorides and sulphur compounds. Deposited grime absorbs contaminated moisture like a sponge and holds it against the powder-coated surface; this permits the attack to proceed thereby damaging the coating, which cannot be restored without removal.

Regular cleaning frequency is dependent on accessibility and the severity of the environment. In industrial and marine environments, in order to remove deposits and restore the appearance, monthly cleaning is necessary and the maximum period between cleanings should never be more than three (3) months.

Under the worst conditions involving heavy grime deposition and atmospheric pollution by both sulphur compounds and chlorides, even more frequent cleaning is advisable if deterioration of the coating is to be prevented. As a general rule, it could be assumed that with outdoor applications, powder-coated aluminium should be cleaned with the same frequency as windows, using a non-abrasive mild detergent solution. Thoroughly rinse surfaces after cleaning to remove all residues.

When dirt and grime is hard to remove, a weak solvent can be used. Ensure that the recommended solutions used only come into contact with the surface for a minimal amount of time. Conduct a test in a place where the surface is not as visible to ensure that there will be no damage to the film or that it will not change colour.

Woodlook / Timbergrain option

"Powderline Woodlook" warranty and maintenance terms attached.



Anodised Finish

The complete louvre system including the framework, blades and tracks are fabricated from aluminium extrusions and are then put through an electrolytic process to create a coherent oxide film that adheres to the aluminium surface.

Wash down the anodised aluminium with warm water containing a suitable wetting agent, or with mild soap solution. Hand rubbing is used for small work, for larger projects utensils such as fibre brushes may be more practical.

More difficult grime deposits may require the use of a mild abrasive such as pumice powder and water. Where greasy deposits are concerned, cleaning may require a soft cloth dipped in white spirits.

It is necessary to thoroughly rinse with water after cleaning, especially where crevices are present to ensure removal of all residues.



REPAIR / MAINTENANCE WORKS

If there are any issues or concerns with our Sunlite louvre system, please complete the attached Maintenance Form and email a copy along with photos to: sales@sunlite.com.au and we will be in contact with you as soon as possible.

We have a minimum call out charge of \$150.00 + GST. This covers travel costs and up to 1 hour onsite to inspect / assess damage.

For additional time required onsite our charge is \$120.00 + GST for each hour thereafter.

Any further works required will be submitted in a written formal quotation and must be accepted in writing by the client before works or site visits are completed. If works are within 5 years of the initial supply date (as per warranty document) or due to faulty workmanship by Sunlite, we will undertake defect works at our own cost.

For any electrical issues please contact Somfy directly first on 1800 076 639 or via their website <https://www.somfy.com.au/support>



WARRANTY

Date: Warranty commences from date of final invoice (Installation/Completion)

Sunlite warrants as follows:-

- A) THAT the louvre system including associated fixings shall remain structurally sound for (5) five years so long as the building structure does not sustain any structural movement in excess of movement considered acceptable by the Australian Standards Association **AND FURTHER PROVIDED THAT** in the event of any works, maintenance or cleaning being performed upon or carried out to any of the materials or works performed by Sunlite and the same are not performed or carried out with the approval of Sunlite or in accordance with Sunlite's specifications, then this Warranty shall be void.
- B) THAT no flaking will occur in the powdercoating which will inhibit the performance of the finished product **PROVIDED THAT** this Warranty shall be limited in scope and extent to the terms or warranties supplied by the manufacturers of materials used as detailed in our correspondence and **FURTHER PROVIDED THAT** in the event of any works, maintenance or cleaning being performed upon or carried out to any of the materials or works performed by Sunlite and the same are not performed or carried out with the approval of Sunlite or in accordance with Sunlite's or Manufacturers specifications, then this Warranty shall be void.
- C) The Sunlite Australia warranty is based on available access to building facade and or canopies. If reasonable access is not available and requires scaffolding, elevated working platform (EWP), and/or stage lifts or similar, then it is the responsibility of the property owners and/or body corporate to provide a safe and secure access in compliance with Australian Occupational Health and Safety Act for remedial and warranty works.
- D) A maintenance log must be maintained on all aluminium items, locks, handles, bearings etc to support any warranty claims. This must detail all products used and all works undertaken, who performed the works and show clear signatures.



CONTACT DETAILS

Address: 14 Mordaunt Circuit, Canning Vale WA 6155

Ph: 08 9351 8880

Email: sales@sunlite.com.au

Web: www.sunlite.com.au